

# TECHNICAL DATA SHEET

## HD08 Tall Basin Mono Mixer

<b>Barcode</b>	0729557187896
<b>Product Code</b>	HD08
<b>Construction</b>	Brass Body CuZn40Pb2, EN CW617N (equivalent to BS CZ122) Zinc alloy Handle
<b>Finishes</b>	Chrome : Ni : 8-12um, Cr : 0.25-0.3um
<b>Product Type</b>	Contemporary
<b>Water Pressure</b>	Min. 0.2 bar, Max. 6.0 bar
<b>Plumbing Systems</b>	Suitable for all plumbing systems
<b>Standards</b>	Complies with BS6920, BS EN200
<b>Certification</b>	Manufactured to comply with ACS
<b>Cartridge</b>	35mm Triduo Ceramic Disc Cartridge
<b>Fitting</b>	UK: M10 x 350mm ½" BSP Female Flexi Tails . EU: M10x350mm 3/8" BSP Female Flexi Tails.
<b>Aerator</b>	Neoperl aerator
<b>Packaging</b>	41.5 x 35 x 36cm / carton (10 boxes / carton) Weight: 2.5kg/box
<b>Guarantee</b>	10 years against manufacturing faults (excluding serviceable parts).
<b>Additional Information</b>	Supplied with G 1¼" sprung waste(UK only)



ALFRED VICTORIA  
ENGLAND  
kitchen & bathroom brassware

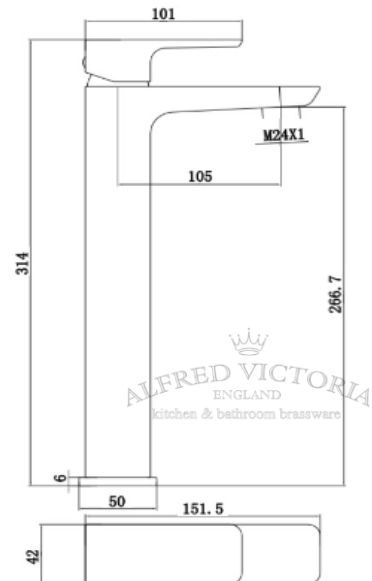

### Flow Rates (Litres per minute)

System Pressure	0.1 Bar	0.2 Bar	0.3 Bar	0.5 Bar	1.0 Bar	1.5 Bar	2.0 Bar	3.0 Bar	4.0 Bar	5.0 Bar
HD08	3.6	4.7	-	7.4	10	12.3	14.2	17.5	-	-

The information contained on this page was correct at date of issue. Fitting dimensions are provided as a guide only. Some variation may occur due to manufacturing tolerances. We pursue a policy of continuing improvement in design and performance of our products and so reserve the right to change specifications without prior notice.

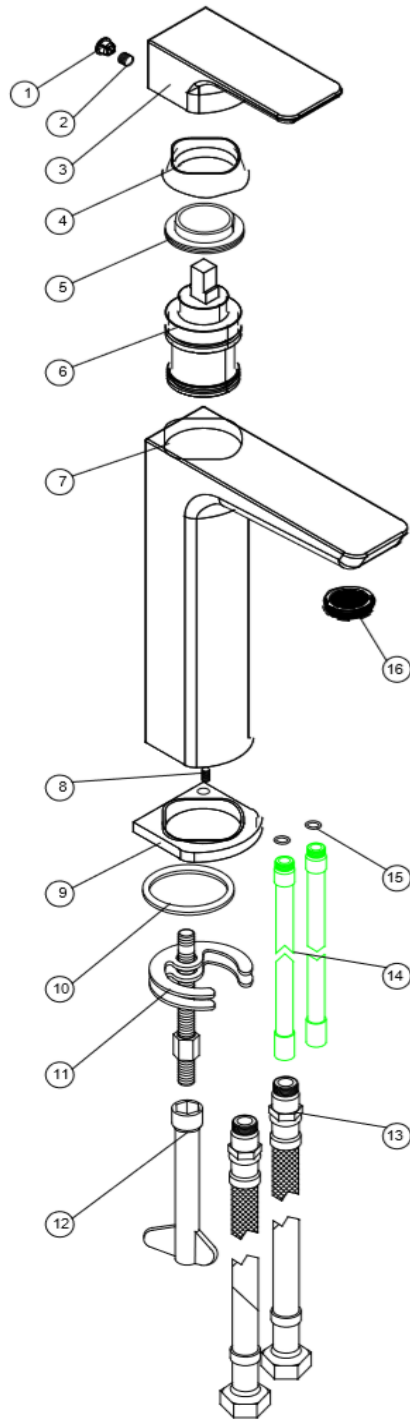

# HD08

No.	DESCRIPTION	QUANTITY
1	COVER	1
2	GRUB SCREW	1
3	HANDLE	1
4	COLLAR	1
5	CARTRIDGE NUT	1
6	CARTRIDGE	1
7	TAP BODY	1
8	SCREW	1
9	BASE PLATE	1
10	WASHER	1
11	M8 FIXING KIT	1
12	SPANNER	1
13	FLEXI TAILS	2
14	PIPE	2
15	O-RING	2
16	AERATOR	1

Alfred Victoria Exploded Drawings			Material:	Assembly	Size:	A4
(Date:D/M/Y)			Scale:	None	Issue No:	01
Drawn by:	Sherman	16/05/2016				
Checked by:	Lee	16/05/2016				
Approved by:	T. K.	16/05/2016				
Drawing Name:						